

Installation & Maintenance instructions for GR-TORI.

Safety Information

Please read these instructions carefully before installing this product and store in a safe place in case of future reference. If you are unsure on the fitting of this product we recommend that you consult a qualified electrician. Install on a flat even surface. This fitting is IP68 rated. When the LED's expire the fitting must be replaced.

Lamp Specification

CCT	3000K
Voltage	12V
Wattage	1.5W
IP Rating	IP68
Class	III (SELV)

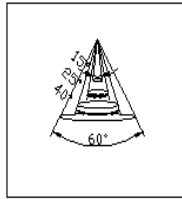
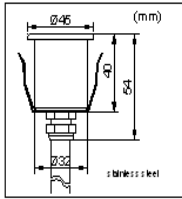

Tool Required

Electric Drill
Hole cutter

Installation:

1. Isolate the power supply before beginning installation.
2. Mark out where you are going to situate the fittings. Make sure that there is enough cable to connect back to the next light or the driver. We recommend ensuring adequate drainage is provided.
3. Cut a 36-38mm hole in the decking.

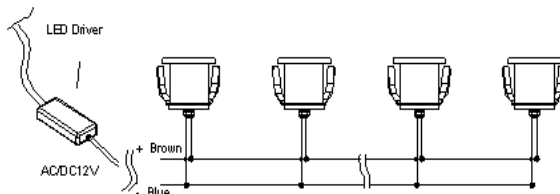
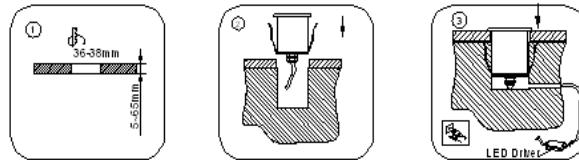

4. If you fitting the deck lights into soil or sand use the installation sleeve included and fill around the fitting.

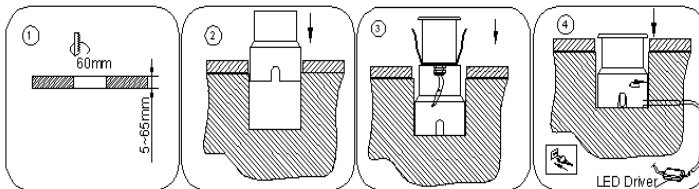

5. Connect all the fittings to the driver before switching the power back on. Once all fittings are installed turn the power on.

Cleaning Instructions

Stainless steel products require regular cleaning to avoid rusting. We recommend wiping down with a soft cloth using warm soapy water or WD40 3-4 times a year.



Not for general waste. Please contact your local authority on how to dispose correctly.